

⚠️ WARNING!

1. Do not plug this shield into any other electric accessories, such as handlebar heaters, etc. This can cause damages to the shield.
2. Always inspect the power supply for any damage prior to operating.
3. The cord must be entirely visible at all times. Never put power supply cord through clothing or get caught on or run over by machine.
4. Before dismounting snowmobile, disconnect electric shield from the power supply cord.
5. Failure to these warnings may result in serious injury or death.

PARTS:



Electric shield

The three cables that come with the electric shield include:

1. **Straight cord**
2. **Coil cord**
3. **Battery cord**

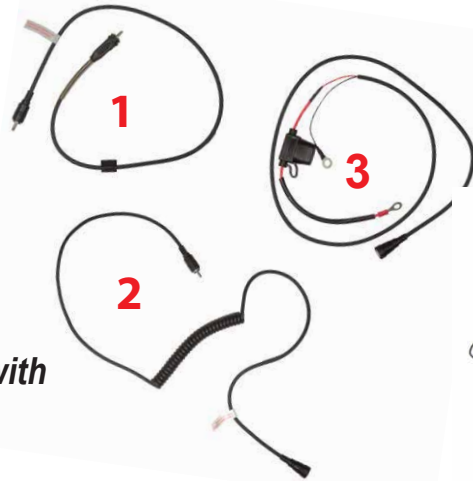

WARRANTY:

This shield is warranted to be free from defect in material and workmanship for the period of 30 days from date of purchase. No returns on broken / damaged cords due to operator error.

INSTALLATION / 400 CRUZ

#9093530



1.) Attach shield to helmet.

2.) Plug **Cable 1** (with arrow sign) in the shield, then turn 90 degrees to the right to lock. (Note: Turn back to left when you need to unlock.)



3.) Open helmet. Remove backing on sticker and place clip on lower left side of helmet.



4.) Attach **Cable 3** to battery terminals. Power voltage should not exceed 16 volts. For safety reasons, please attach wire to the appropriate connection and secure excess cord to an accessible part of steering column, away from moving parts. (Red is positive.)

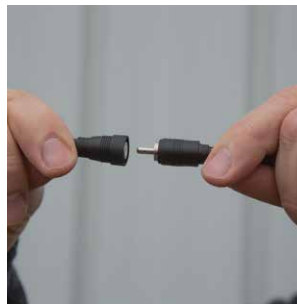

5.) Connect **Cable 2** between Cable 1 and Cable 3.